

# KWW 72

Window Wall Systems

Elevate your space with a sleek all-glass look.

Upgrade your space with KWW72 and enjoy its exceptional aesthetic appeal, high thermal performance, slab edge cover integrity, seamless integration, and durable construction. Experience the beauty of structural bonding technology and elevate your architectural vision to new heights.

### Key Features

System Visible Width	2" 7/8
System Depth	4" 1/2
Max. Glazing Thickness	1" 1/16
Max. Sash Height	8' 2"
Max. Sash Weight	440 Lbs

**Aesthetic Appeal:** KWW72 is designed to enhance the visual appeal of any space with its sleek and modern all-glass look. The structural bonding technology ensures seamless joints and a clean, uninterrupted appearance, creating a sophisticated aesthetic that complements contemporary architectural designs.

**High Thermal Performance:** Despite its focus on aesthetics, KWW72 doesn't compromise on thermal performance. It incorporates advanced insulation materials and techniques to minimize heat transfer, ensuring energy efficiency and comfortable indoor environments.



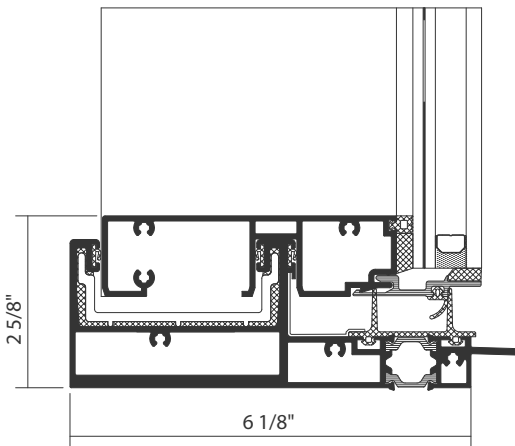
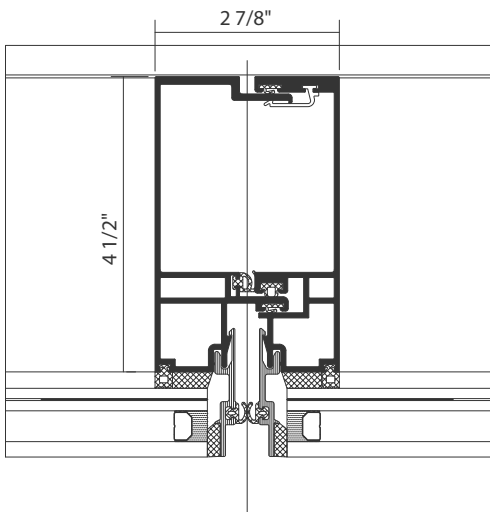

**Slab Edge Cover Integrity:** KWW72 features a unique slab edge cover design that enhances the overall integrity of the system. This innovative feature not only provides a clean and finished look but also ensures structural stability and weather resistance, making it ideal for diverse environmental conditions.

**Seamless Integration:** KWW72 seamlessly integrates with doors and other building elements, providing a unified look throughout the facade. The structural bonding technology allows for flexible configurations and customization options, ensuring a perfect fit for your project's unique requirements.

**Durable and Secure:** With its robust construction and advanced bonding methods, KWW72 offers durability and security. The bonded glass panels provide enhanced resistance to environmental elements and ensure long-lasting performance, making it a reliable choice for various applications.



### Performance Values

	ASTM E 283	Air Infiltration	<0,1 cfm/sq.ft @ 6.24 psf
	ASTM E 331	Water Resistance	+12 psf
	ASTM E 330	Wind Load	±60 psf
	NFRC	U Factor	0,28-0,37 Btu/(h.ft².F)
	NFRC	SHGC	0,25 - 0,40

## KLEIDCO®

KLEIDCO Building Solutions  
 33 Nassau Ave. Brooklyn, NY 11222  
 usa.kleidco.com | +1 (917) 583-0375

